



agriculture & rural development

Department:
agriculture
& rural development
PROVINCE OF KWAZULU-NATAL

INVITATION OF QUOTATION ABOVE R30,000.00

THIS FORM SHOULD BE COMPLETED IN DETAIL AND SHOULD BE ACCOMPANIED BY A **VALID TAX COMPLIANCE STATUS PIN AND VALID BBBEE VERIFICATION CERTIFICATE/AFFIDAVIT**

QUOTATION NUMBER: R/N/1819/177	VALIDITY PERIOD OF QUOTATION..... Days (To be completed by the Supplier)
CLOSING DATE: 21 SEPTEMBER 2018	CLOSING TIME:11H00
DESCRIPTION(SPECIFICATION/S) OF ITEMS/ SERVICE REQUIRED: To supply , deliver and erect goat shed Nogwaja Makhabeleni Umzinyathi District	COMPANY NAME: TEL NO: FAX NO: CONTACT PERSON: CSD REG NUMBER MAAA.....
DOES OFFER COMPLY WITH SPECIFICATION?	YES/NO (DELETE WHICH EVER IS NOT APPLICABLE)
DOES ARTICLE COMPLY WITH SABS SPECIFICATION? HAS IT BEEN INSPECTED BY SABS?	YES/NO YES/NO (DELETE WHICH EVER IS NOT APPLICABLE)
DELIVERY PERIOD AFTER INITIAL ORDER?	
IS THE PRICE FIRM	
WHERE ARE THE STOCK HELD? (PHYSICAL ADDRESS , PLEASE)	
QUOTATION PRICE INCLUDING VAT (VAT TO BE ADDED BY REGISTERED VAT VENDORS ONLY)	TOTAL: R
COMPANY OFFICIAL STAMP (COMPULSORY) SIGNATURE OF BIDDER DATE
NUMBER OF PAGES SUBMITTED BACK TO THE DEPARTMENT BY THE SUPPLIER(Supplier to complete)

NB: QUOTATION FOR THE ATTENTION OF: Bonnie Nzimande
TELEPHONE NUMBER: 033 355 9568

NB:
THE ATTACHED SBD4 & SBD9 FORMS MUST BE COMPLETED IN FULL.
THIS REQUEST FOR QUOTATION (RFQ) MUST BE COMPLETED AND RETURNED WITH ALL YOUR QUOTATION DOCUMENTS.

QUOTATIONS MUST BE DEPOSITED IN THE BID BOX SITUATED AT: THE DEPARTMENT OF AGRICULTURE & RURAL DEVELOPMENT: LOT 11634 , ALOE LOOP STREET, VELDENVLEI, RICHARD BAY , OPPOSITE UMHLATHUZE SPORT GROUND

ANNEXURE A

Umzi/fs 18/Anim Struc/umv/goats

COMPANY NAME
ADDRESS
CONTACT PERSON.
CONTACT NUMBER

FAX NUMBER 086 561 3223

LINE NO.	DESCRIPTION OR SPECIFICATION OF ITEM <small>(Please be very specific and clear)</small>	REQUIRED QUANTITY	UNIT PRICE EXCL. VAT		TOTAL PRICE	
			R	C	R	C
	To Procure, Supply, Deliver, erect and construct goat shed material to Makhabeleni Area, ward 01, S 29 13 47.2 E 30 54 47.5 No 67A JA					
	See attached, design and the bill of Quantities					
* LABOUR (IF APPLICABLE)						
*DELIVERY (IF APPLICABLE)						
TOTAL						
*ONLY APPLICABLE TO VAT REGISTERED SUPPLIERS 15% VAT						
TOTAL PRICE						

*VAT Registration No. (Supplier) -----

When Required (Requester): August 2018
Where Required (Requester): Umvoti Local offices
Contact details of requester: TT Mnguni TEL : 033 413 2155/ 082 454 7741
(COMPULSORY)

COMPANY STAMP



PRICES ARE VALID FOR..... DAYS

SIGNATURE

DATE



**agriculture
& rural development**

Department:
agriculture
& rural development
PROVINCE OF KWAZULU-NATAL

**BID DOCUMENT FOR THE
CONSTRUCTION OF A GOAT SHED FOR 100 ANIMALS**

Project: NOGWAJA GOAT PROJECT

1. This document must be read in conjunction with Drawings 1, 2, 3 & 4 (See Table of Contents). If the contractor has the impression that the information provided in the drawing(s) and the technical specifications/Schedule of quantities contradict each other or are perceived to be ambiguous, (s)he should point this out to the Engineer and ask for clarification at an early stage, but not later than before the commencement of any construction. The same applies for purported differences between the technical specifications and schedule of quantities.
2. The Engineering Services Section (ESS) takes no responsibility for goat sheds built on the basis of this document alone without any prior involvement of ESS before (partial) completion. This involvement consists of, but is not necessarily restricted to:
 - a. Signing off of the bid/quote document and Drawings by ESS;
 - b. Presence of ESS at the handover of the site to the contractor and at the commencement of the work. The contractor is to make sure that ESS is informed of his/her intention to commence the work so that ESS presence can be assured.
 - c. Supply to the contractor by ESS of A3 size plans. The drawings supplied with this document are for quoting/bidding purposes only and no construction should take place before the contractor has received the bigger sized building plans.
 - d. Regular site inspections by ESS and the processing of invoices on the basis of achieved progress.
3. District managers and other departmental end users are therefore required to involve ESS at the earliest possible stage, i.e. during PPC meetings or before submission of the request memo is submitted.

Table of Contents:

No.	Section	Page(s)	Action
1	A - Project Particulars	2	Read
2	B - General Conditions of Contract	2 - 9	Read
3	C - Project Technical Specifications	10 - 16	Read
4	ANNEXURE A: Pricing Summary	17 - 18	Complete
5	ANNEXURE B : Payment Schedule	19	Read
6	ANNEXURE C : Additional Information	20 - 21	Complete
7	DRAWING 1: EXTERIOR	DR01	Read
8	DRAWING 2: TIMBER FRAME	DR02	Read
9	DRAWING 3: DETAIL PALLETS & TOP VIEW FRAME WORK	DR03	Read
10	DRAWING 4: CORNER DETAILS	DR04	Read



A) PROJECT PARTICULARS

1) PROJECT DESCRIPTION / BACKGROUND:

The contract covers the supply of all material and fittings and construction of a 12.00 x 8.00 x 3.10m goat shed and associated works (fencing). Documents to accompany this bid specification are listed on the cover page.

2) LOCATION

District: UMZINYATHI

Local Municipality: UMVOTI

The site is situated at approximately km N /S /E /W of.....

3) SCOPE OF WORKS

The contract covers the supply of all material and fitting and construction of all works relating to the goat shed and fencing. The following are the scope of works for the project.

Details of these works are specified in *Section C: Project Technical Specifications*.

- Site establishment.
- Earthworks: Excavate topsoil from the area to be concreted over. Compact soil to 95% ModAASHTO.
- Setting out of shed and digging of the holes for the poles;
- Supply all materials required for the structure and entire works (throughout contract).
- Cast concrete around poles and erect timber structure as per specifications and drawings.
- Cast floor concrete in panels of 2.5 x 2.5m in accordance with drawings and specifications;
- Fixing of corrugated iron sheets, weld mesh and gate to pole framework;
- Brickwork: pillars for pallets;
- Supply material for and erect fencing according to drawing and specifications.

B) GENERAL CONDITIONS OF CONTRACT

BID DOCUMENTATION:

1) BIDDERS TO CHECK COMPLETENESS OF DOCUMENT

The Bidder is required to check the number of consecutively numbered pages and should any found to be missing or in duplicate, or the text of figures indistinct, or should there be any doubt or obscurity as to the meaning of any part of these documents, the Bidder must ascertain the true meaning or intent of the same prior to the submission of his/her Bid, as no claims arising from any incorrect interpretation will be admitted.

2) SCHEDULE OF VARIATIONS

If the Bidder chooses to suggest alternatives in his bid proposal, these should be *at least* of equal standards to the original specifications. All materials used must be SABS approved. In the case of variations being suggested, Section K of Bid form ZNT 1 will have to be completed.

3) APPLICABLE STANDARDS: SPECIFICATIONS & MATERIALS

For the purpose of this Contract the relevant SANS specifications shall apply- specifically SABS 1200: *Standardized Specification for Civil Engineering Construction* specifications shall apply. The following sections shall in particular apply here: SABS 1200 AA - 1986 (General - Small Works), SABS 1200 DA -1986 (Earthworks - Small Works) and SABS 1200GA - 1982 (Concrete - Small Works). All materials to be SANS approved and installed to applicable standards specified by SANS, NBR, or the manufacturer. The Bid shall refer to "the Standard (Abridged) Preamble for all trades", which covers the following (only the items in italics apply to this contract):



**STANDARD (ABRIDGED) PREAMBLES TO ALL TRADES
INDEX**

		Page
1	EARTHWORKS	3
2	CONCRETE, FORMWORK AND REINFORCEMENT	3
3	BLOCK AND BRICKWORK	6
4	WATERPROOFING	8
5	CARPENTRY AND JOINERY	8
6	FLOOR COVERINGS, PLASTIC LININGS, ETC.	11
7	IRONMONGERY	13
8	SCREEDING AND PLASTERING	16
9	TILING	18
10	DRAINAGE AND PLUMBING	19
11	SANITARY PLUMBING AND FITTINGS	25
12	FIRE EXTINGUISHERS	31
13	GLAZING	31
14	PAINTING	31

4) VALIDITY PERIOD FOR BID

Bids shall remain valid for a period of 90 days from date of the closing of the Bid.

SITE CONDITIONS AND FACILITIES AVAILABLE:

5) COMPULSORY PRE-BID BRIEFING MEETING

A compulsory pre-Bid site briefing and consultation meeting will be held with prospective Bidders. Attendance at the meeting will be compulsory and non-attendance shall invalidate any Bid. The date and time of the meeting will be published in the Bid Advertisement.

6) HANDOVER OF SITE TO CONTRACTOR

The Contractor will be introduced to the project participants following the Bid award. The site will be handed over to the Contractor who will control the site for the contract duration. Only the Contractor's own employees, Contractor's local labour and Departmental Representatives will be allowed on site. The Contractor is responsible in the administration, control and security on the site at all times during the contract duration.

7) WATER AND POWER

There is no power or piped water available on site. The Contractor shall make the necessary arrangements for the provision of any water and power. No payment will be made for the provision or use of these services and the cost of these shall be included in the Bid/quoted amount.

8) LOCATION OF CAMP

The Contractor's camp may be erected on the site of the works but must meet the approval of the Engineer, project beneficiaries and land owners. No persons other than a night watchman may sleep in the camp, without the approval of the local participants and Chairperson.

9) HOUSING OF CONTRACTOR'S EMPLOYEES

No housing is available for the Contractor's employees and the Contractor shall make his own arrangement for housing his employees and transporting them to and from the site. However it may be possible to arrange temporary local accommodation for the Contractor's staff with the participants. The Contractor is in all respects responsible for the housing and transporting of his employees, and for the arrangement thereof, and no extension of time due to any delays resulting from this, will be granted.

10) LOCAL LABOUR

Unskilled labour may be available from the project participants or local community. The Contractor and the Departmental representative (Engineer or local Extension officer) may negotiate with the participants in this regard to establish all the conditions for the utilization of the local labour. Nobody besides those directly involved with the project (ie: the Contractors workers and local labour) are allowed on site. The Contractor shall provide his own



trained and skilled labour. The Contractor will be responsible for all hiring, payment, housing and transport of any and all labour used for the contract duration.

11) SECURITY & RISK

Except for the necessary security personnel no person shall be allowed on the construction site after normal working hours. The Contractor shall be responsible for all plant, machinery, equipment and materials on site. The Engineer shall not be responsible for any lost, damaged or stolen property or materials. Should any of these situations arise, no allocations will be made in terms of finances or time.

12) MATERIALS: DELIVERY, ON & OFF-LOADING, STORAGE AND RESPONSIBILITY

The approved contractor shall be responsible for the safe delivery, loading, off-loading, handling and storage of any equipment and materials on site. All equipment, materials and plant stored on site must be suitably protected against deterioration through any cause whatsoever, including damage or loss by theft or otherwise. The Contractor shall remain fully responsible for all material and plant etc. until the completed works are handed over and has been officially accepted by the Department.

13) EXISTING ROADS, MUNICIPAL PAVEMENTS, ETC.

The Contractor is advised that he will be held responsible for any damage to the existing pavings, roads, municipal pavements, fences, boundary walls, etc., and will have to make good at his expense.

14) DAMAGE TO PROPERTY

If the Contractor or his workmen while engaged in the execution of the contract, shall break, deface, injure, destroy or allow to fall into disrepair any part of the Works or property belonging to the Employer, or any private property including: buildings, pavings, roads, fences, walls or grounds contiguous to the premises of the Employer on which he or they may be employed, the Contractor will be required to make good, in a perfect and workmanlike manner, at own expense all damage to the approval of the Employer. The Completion Certificate will not be issued until the Employer is satisfied that all necessary remedial work has been satisfactorily completed.

The Contractor shall take every precaution against damage or nuisance being caused by dust both to the properties of the Employer and all surrounding properties and shall indemnify the Employer against any claim that might arise there from.

15) UNDERGROUND CABLES AND PIPES

If such services is/are discovered, immediate notification must be made to the Employer and all work in the vicinity of such cables, pipes, etc., shall cease until safe to proceed. Should the Contractor damage underground cable or pipes such damage shall be repaired as soon as safe and possible by the Contractor. The cost of making good such damage will be met by the Contractor as this must be covered by the Contractors works insurance.

16) DAILY RAINFALL RECORDS

The Contractor shall keep **daily rainfall records** and submit them to the Department's representative at every site meeting, or fortnightly by fax in the absence of such visit. No additional payment shall be made for the supply and installation of the rain gauge or for the keeping of the rainfall records and all costs must be included in the scheduled items. Submission of rainfall figures is required for the granting of permission of extending the contract period on the basis of inclement weather.

INSPECTIONS:

17) INSPECTION OF WORK

The Head of Department or his Representative may at all reasonable times have access to the Works and/or the workshops or other place where work is being prepared for this Contract for inspection. The Engineer may request that evidence of the quality or strength of any materials be supplied by the contractor as may think necessary. Should the Head of Department or Representative consider any materials objectionable or if it shall appear to him at any time during the construction, or prior to the expiry of the defect liability period, that any part thereof has been executed with unsound or imperfect materials or with unskilled or imperfect workmanship, the Engineer will notify the Contractor who shall cause the objectionable materials to be instantly removed from the premises and to be replaced by good and suitable materials, and shall rectify or reconstruct the Works in whole or part, as the case may be at the Contractors own proper cost or charge.



18) NOTICE OF COVERING WORK

The Contractor shall give due notice to the Head of Department or Representative whenever any work or materials are intended to be covered in with earth or otherwise in order that their correct dimensions and quality may be ascertained before being covered, and in the event of any such work or materials being covered without such notice having been given, the work or materials shall be uncovered at the Contractor's expense on instructions given by the Employer.

19) COMPETENCY OF THE CONTRACTOR:

This bid is open for contractors with a Construction Industry Development Board (CIDB) data base grading of at least 2CE/GB. The contractor is to submit evidence of his/her OWN registration. CIDB registration of possible sub-contractors would be recommended, but will not make up for non-registration by the contractor quoting/bidding for the work. The Department reserves itself the right to disqualify any quote/bid in the event of substantial unsatisfactory reports being obtained about the proponent of such a quote/bid.

20) CONTRACTOR TO PROVIDE EVERYTHING NECESSARY

The Contractor shall provide everything necessary for the proper execution of the Works according to the true intent and meaning of the Drawings and Specification taken together. The Contractor shall provide without extra charge all assistance and everything reasonably necessary for proving the quality of work done as may be required by the Regional Engineer.

21) SUB-CONTRACTED WORK

The contractor must indicate in **Annexure C2 – Additional Information: Subcontracted works** which part(s), if any, (s)he intends to subcontract. In case the contractor decides to subcontract part of the work (s)he shall obtain written consent of the Engineer, which shall not be unreasonably withheld. Any such consent shall not relieve the contractor from any liability or obligation under the contract and he shall be liable for the acts, defaults and neglects of any sub-contractor, his agent or employees as fully as if they were the acts, defaults or neglects of the contractor, his agents or employees.

22) VARIATIONS / 'AS BUILT' DETAILS

No variations or alterations may be made without the prior approval of the Regional Engineer or his delegated representative. As the work progresses, the Contractor shall keep full records of all amendments to and deviations from the specifications as issued to the Contractor at the start of the contract. These details will, where appropriate, be noted on the supplied drawing. All alterations will be deemed to have a zero additional cost implication. If any additional works are required that have an additional cost implication then these must be handled as a contingency and must first be authorized in writing by the Regional Engineer. Refer to notes on contingencies.

23) VERIFICATION OF EXPERIENCE

The proponent of a bid/quote will be required to produce adequate and sufficient references to enable the Department to inspect previously completed projects and assess his/her capacity. He/She shall provide such information in **Annexure C3 – Additional Information: Experience**.

24) EQUIPMENT & RESOURCES

The proponent of a bid/quote shall in **Annexure C1 – Additional Information: Equipment and Resources** and by way of supplementary information satisfy the Department that sufficient equipment is possessed to execute the services or an indication shall be given as to the manner in which such equipment would be sourced. Should (s)he not be able to prove possession of or ability to access sufficient equipment, the Bid/quote will be wholly disqualified. The Department reserves the right to investigate the existence and/or proposed sourcing of equipment.

25) LABOUR CAPACITY

The proponent of a bid/quote will be required to satisfy the Department that a sufficient and experienced labour force is employed or that sufficient experienced labour can be acquired to complete the services and produce a fair quality of workmanship. The Contractor shall only employ such persons on the Works as are thoroughly efficient and of good character. If in the opinion of the Head of Department or Delegated Representative any person employed by the Contractor misconducts himself or is likely to cause or has caused quarrels, or delay, or is incompetent, the Contractor when so directed by the Head of Department or Delegated Representative shall at once remove such person from the site.



26) LOCAL AND OTHER AUTHORITIES NOTICES AND FEES

The Contractor shall comply with and give notices required by any Act of Parliament, Act of the KwaZulu-Natal Provincial Legislature, Laws, Regulations and By-Laws of any Local Authority and/or any public service company or authority relating to the Works or with whose systems the same are or will be connected, and he shall pay and indemnify the Employer against any fees or charges demandable by law thereunder in respect of the Works provided that the said fees and charges, if not expressly included in the Contract Sum or stated by way of Provisional Sum shall be added to the Contract Sum and be payable to the Contractor accordingly.

The Contractor before making any variation from the Drawings and Specification necessitated by such compliance shall give to the Regional Engineer written notice specifying and giving the reason for such variation and applying for instructions in reference thereto. If the Contractor within twenty-one days does not receive instructions he shall proceed with the work conforming to the provision, regulation or by-law in question, and any variation necessitated as aforesaid shall be deemed a variation and dealt with as such.

27) INSURANCE

All accepted approved contractors would be required to provide the following insurance's for the project awarded to them:

- Registration with the Compensation Commissioner and compliance with the Compensation for Occupational Injuries and Diseases Act with regard to insurance.
- Unemployment insurance fund for all workers.
- Insurance against damage, destruction or loss caused by fire.
- Public Liability insurance.
- All risks (works) policy and Political for the value of the respective project plus 10%.

28) PROTECTION OF THE PUBLIC

The Contractor will be required to pay particular attention to watching and warning lighting and must provide any necessary barriers, etc., required for the protection of the public in terms of the existing Occupational Health and Safety Act, 1993 (Act No. 85 of 1993) as amended.

29) SITE SAFETY

During the construction the regulations of the Occupational Health and Safety Act No. 85 of 1993 and Machinery and Occupational Safety Act (Act 6 of 1983) will apply. By submission of a Bid/Quote the proponent acknowledges and agrees that, should this Bid/quote be accepted, (s)he is an employer in his own right with duties as prescribed in the Occupational Health and Safety Act No. 85 of 1993 and amendments thereto and the corresponding Construction Regulations 2003 will ensure that all Works to be performed or machinery and plant to be used in the Works will be in accordance with the provisions of such regulations.

(S)he also agrees that he is aware of the fully understands all the provisions of such regulations. All equipment, machinery, tools and safety equipment used on site are to be in a safe operating condition and are to be used in a safe and considerate manner by suitably trained and experienced workers. The Contractor is responsible for all such monitoring and control of site operations and equipment throughout the works for the entire contract duration. All necessary safety equipment required to construct the facility must be used by the workers where appropriate and are for the contractor's responsibility and provisioning. A first aid box is to be provided and available at all times on site during working hours and is to comply with the requirements of the Occupational Health and Safety Act. The Contractor shall ensure the safety of all work left standing in an incomplete state during the construction and shall be responsible for all damage or loss caused by his failure to ensure the safety of such incomplete work.

Site operations requiring special attention include but are not limited to: Any excavations; plant, machinery and equipment operations; any chemical storage and usage whatsoever; any works requiring elevated personnel such as for roofing, elevated building works requiring ladders or scaffolding etc...; any works with overhead elevated operations or construction. Please also refer to item "Safety" in *Section C: Project Technical Specifications*.

30) PROTECTION OF THE PUBLIC

The Contractor will be required to pay particular attention to watching and warning lighting and must provide any necessary barriers, etc., required for the protection of the public in terms of the existing Occupational Health and Safety Act, 1993 (Act No. 85 of 1993) as amended.



31) INJURY TO PERSONS

The Contractor shall be liable for and shall indemnify the Employer/Engineer in respect of any liability, loss, claim or proceedings whatsoever, whether arising in Common Law or by Statute in respect of personal injuries to or death of any person whomsoever arising out of or in the course of or caused by the execution of the Works.

32) DISAGREEMENTS

a) Notice of disagreement

The Contractor has the right by written notice to the Engineer to require him to consider any disagreement which he raises with the Engineer provided the said written notice shall be given within 14 days after the cause of disagreement has arisen.

(b) Ruling on disagreements

The Engineer shall give a ruling on the disagreement in writing to the Contractor no later than 14 days after his receipt of a written request from the Contractor requiring him to do so, failing which he shall be deemed to have given a ruling dismissing all the Contractor's contentions.

33) FIXED PRICE CONTRACT

The contract shall **not** be subject to contract price adjustment. Proponents of Bids/Quotes must therefore allow for increase cost for the contract duration, including possible delays in awarding the Bid in accordance with the validity period.

34) PRICING - COMPLETENESS OF BID/QUOTE

- i. Proponents of Bids/Quotes will be required to Bid for all services, products and commissioning as specified in this document and associated plans. If (s)he does not Bid/quote on all items, his/her Bid/quote may be rejected.
- ii. All bid/quoted prices for separate items are to be in South African currency and must exclude VAT.
- iii. All items as described in the project specification are to be priced in full.
- iv. Transport/Delivery costs must be included in the pricing. It must not be a separate item.
- v. VAT must be filled in as the sub total followed by the complete price for the entire project.
- vi. The Bid price must have your company stamp, date and be signed by an authorised person.

35) QUANTITIES OF WORK

The Contractor shall receive payment only for the works actually executed and approved by the Engineer. No claim for an extra or for any addition, or for any variation shall be entertained unless such extra, addition or variation was ordered in writing by the Head of Department. Such a variation will be dealt with as a contingency only if the variation has an additional cost implication. See item on 'contingencies'. No objection to the description or terms of the Order in Writing will be entertained unless lodged in writing with the Head of Department within twenty-one (21) calendar days of the date of the order.

36) PROGRESS PAYMENTS

The contractor may submit claims for progress payments only on completion of the hereunder listed levels. Payment shall only be paid for claims which are commensurate with the works actually executed and complete. NOTE: Payment will only be made against the construction progress as pertaining to built items. Movable items and materials on site are generally excluded from progress payments until they have been fully installed or fitted or built up. If any item or part of an item in an invoice is disputed by the Engineer, the Engineer shall give notice of such with reasons.

The contractor shall be paid in up to a *maximum* of seven (7) installments. Refer to **ANNEXURE B: Payment Schedule** for the values of each phase. These values shall be adhered to during the payment process. Part payments will be made after the Department has approved the completion of each construction phase, in accordance with the retention clause (see below). The penultimate payment occurs after practical works completion. The final payment will be made after the 90 day retention period when the contractor has dealt with all defects, if any.

37) RETENTION

A 10% retention will be withheld on payment for each of the 6 construction phases. The Department will pay out half of this retention, or 5% of the bid value, as part of the sixth payment, at **practical completion** of the works. The remainder, viz 5%, will be paid out at **final completion** after expiry of the defect liability period (90 days after practical completion), the bidder having eliminated all defects. See **ANNEXURE B: Payment Schedule** for details.

**38) DEFECT LIABILITY PERIOD**

The contractor shall unconditionally guarantee all materials, workmanship related to the works for a minimum period of three (3) months. The guarantee shall cover any defects due to inferior materials and/or workmanship of the Contractor, or any of his sub-contractors, fair wear and tear excepted. The Contractor shall repair, remedy or replace any such defects, part or complete works without delay and at his own cost.

If any defects are not remedied within the period specified by the Head of Department, then the Head of Department shall have such defect repaired at the risk and cost of the Contractor by another Contractor whom the Head of Department deems to be proficient in the work without prejudice to any rights the Head of Department has against the defaulting contractor. The Head of Department will give written notice to the Contractor of such instances where he appoints another Contractor to remedy defects in the works.

39) ANCILLARY MATERIALS AND EQUIPMENT

A fixed amount of R 20,000 has been set aside in the Pricing Schedule (item #46) to cover any unforeseen expenditure not provided for in the Schedule of Quantities and which could occur due to project specific circumstances. If such a situation were to occur according to the contractor, he will notify the Engineer and seek his approval for expenditure against this item. Provided that approval was given, the contractor will be paid proven expenditure, plus a 10% mark up.

40) SERVICE LEVEL AGREEMENT

The successful Bidder and the Department will sign a Service Level Agreement prior to commencement of works. A proposed schedule of works must be provided by the contractor for the approval of the Engineer within 2 (two) weeks of receiving notification of a successful bid. A required payment schedule will be made in accordance with % works complete (based on installation/work completed on site). Verification of the % complete will be at the sole discretion of the Engineer.

41) COMMENCEMENT OF THE WORKS

The Department will organize a site hand-over to the contractor who will then be introduced to the project stakeholders and participants. The site shall only be accessible to contractor staff and Departmental representatives while work is in progress. The site will be handed back after practical completion. Site establishment must start within two weeks, and the actual works within three weeks after hand-over of the site, provided that an official order has been issued and that no exceptional circumstances such as inclement weather or other outside the control of either party to the contract prevail. In the case the work has not commenced within three weeks of the hand-over and no attenuating circumstances for the delay can be provided, the Department reserves itself the right to cancel the contract and appoint one of the other contractors that have Bid for the works.

42) RATE OF PROGRESS

The Works shall be completed within the time period indicated on the official order form.

If the Works are delayed by cessation of work by any workmen, inclement weather, or by any omissions, additions, substitutions or variations of the Works, or of any items of work, labour or material, or by any other causes beyond the Contractor's control then the Contractor shall have the right within twenty-one days of any such cause of delay arising, to apply in writing to the Department to extend the date of completion, stating the cause of delay and period of extension applied for. The Department upon receipt of such written application may by order in writing extend such date of completion by a period to be determined, or may refuse to extend such date of completion, or may postpone giving a decision upon such application until completion of the Contract period set out in sub-clause (a) of this clause. The date of completion will be extended only to the extent approved by the Department.

Should the Contractor fail to apply in writing for an extension within the time set out above, or should the Department refuse to grant any extension in writing, then the Contract period provided by sub-clause (a) of this clause shall not be exceeded. When the Works are completed the Department will give a completion certificate and the date of such certificate shall be the date of commencement of the guarantee period.

43) TIME TO BE OF THE ESSENCE

Time shall be considered as the essence of the Contract. If, therefore, the Contractor fails to commence work or the Works or to proceed with and complete the Works in compliance with the projected timeframes, then the Head



of Department shall have the right in his/her absolute discretion to adopt and exercise all or any of the following courses wholly or partly, viz: -

- To direct the Contractor, in writing, on any day named therein to suspend and discontinue the execution of the Works, and to withdraw himself and his workmen from the said Site or Sites, and thereupon: -
- To make any Contract or Contracts by calling for Bids or otherwise with any other Contractor or Contractors for the completion of the Works, or any part thereof, at such times and upon such terms as to the Department shall deem best.
- To provide such number of men, or purchase such materials, or both provide the men and purchase the materials as to him shall seem fit and proceed with and complete the said Works.

In relation to the foregoing provisions the Department shall charge any sums of money which may be paid by the Department for completing the said Contract against the Contractor and if such amount shall exceed this Contract, then the Department shall have the right to recover such excess or any balance thereof from the Contractor by legal proceedings.

44) PROGRAMME AND PROGRESS PAYMENTS (AFTER CONTRACT AWARD)

The contractor is to supply a Gantt chart with the proposed times of completion of each phase and associated progress payment request for the project. At least four (4) progress payments are suggested at any of the stages as detailed in *Annexure B*.

45) PERIOD OF COMPLETION

The project is to be completed within 3 months of award of the contract (90 calendar days).

46) PENALTY CLAUSE / FINES FOR LATE OR NON-COMPLETION

If the contractor does not complete the work within the time stipulated and no extenuating circumstances can be given for the delay, the Department may impose a fine as detailed below. The total will be subtracted from the retention allowance. If the contractor fails to complete the works and the Department is forced to employ another contractor to complete the works, the defaulting contractor will be held liable for the costs as far they exceed the original total Bid value. Refer also to the breach of contract and penalty clauses in ZNT 6, condition 4, section B. The Engineer may decide to deduct a penalty for late completion of up to 0.05% of the contract value per working day delay. This will be deducted from the retention.



C) PROJECT TECHNICAL SPECIFICATIONS

1) SCOPE OF WORKS

- .1 Site establishment.
- .2 Earthworks: Excavate topsoil from the area to be concreted over. Compact soil to 95% ModAASHTO.
- .3 Setting out of shed and digging of the holes for the poles;
- .4 Supply all materials required for the structure and entire works (throughout contract).
- .5 Cast concrete around poles and erect timber structure as per specifications and drawings.
- .6 Cast floor concrete in panels of 2.5 x 2.5m in accordance with drawings and specifications;
- .7 Fixing of corrugated iron sheets, weld mesh and gate to pole framework;
- .8 Brickwork: pillars for pallets;
- .9 Supply material for and erect fencing according to drawing and specifications.

2) PRELIMINARIES AND GENERAL

The contractor is to note that all insurances (UIF, workmans compensation, works, public liability etc.); site and equipment safety; site establishment and security; services (water and electricity); testing of materials and any specialist services are for the contractor's responsibility and attention throughout the contract duration until handover of the project. The Department reserves the right to stop progress of the works in case of non-compliance until these conditions are complied with.

3) EARTHWORKS AND SITE PREPARATIONS

Normal regulations regarding safety, municipal by-laws, contamination of water sources, erosion, siltation etc. will still apply. Site preparations & establishment: SABS 1200 AA (4). Setting out of works: SABS 1200 AA (5.1.1)

- .1 The site must be cleared and stripped of all plant materials, roots and topsoil prior to site leveling.
- .2 The cleared and stripped material is to be stockpiled away from the construction site and is to be leveled/replaced once all construction is complete.
- .3 The site is to be leveled prior to any construction. The floor base should be compacted and sloped as indicated on the drawing (1.5% across towards the centre and 1% longitudinal).
- .4 Compaction of the site shall take place at optimum moisture content (OMC) to a maximum dry density of at least 95% of Mod. AASHTO. The Contractor shall arrange independent compaction testing, before the floor slabs are cast. Four (4) distributed places per site shall be tested, once off, after completion of the compaction of the floor base. (test results are to be provided). The floor is to be inspected prior to the pouring of any concrete.

4) MATERIALS AND CONSTRUCTION

All materials must conform to SABS specifications for the products. This includes all items such as bricks, blocks, brick reinforcement, damp proofing, lintels, glazing, plumbing and drainage etc...All construction works must conform to the applicable standard specifications and installation requirements as per NBR requirements and manufacturers recommendations. All concrete works to conform to CNCI standards and recommendations.

5) STANDARD CONCRETE MIXES:

- Mixing, pouring and curing of concrete: SABS 1200 GA (5.4)
- Materials: SABS 1200 AA (3); SABS 1200 GA (3)
- Cement: Common cement 32,5N or R to SANS 50197-1
- Testing: SABS 1200 AA (7); SABS 1200 GA (7)
- Quality control through the slump test SABS 1200 GA (5.4.1.2) SABS method 862.
The contractor is to supply the slump testing equipment.
- Tolerances to SABS 1200 GA (6.4)
- Formwork: Refer to SABS 1200 GA (4.4; 5.2)
- Reinforcing: SABS 1200 GA (5.1)
- Refer to standard concrete mixes specification.
- Refer to surface finishes specification.



STANDARD CONCRETE MIXES:

Concrete for non-structural purposes shall be "Prescribed mix concrete" produced in accordance with the requirements indicated in table 5.1, and the Contractor is also referred to the foregoing preambles insofar as they apply.

Class of Concrete	Estimated Minimum Compressive Strength in MPA at 28 Days	Maximum Nominal Size of Coarse Aggregate in mm	Proportion of Constituents		
			Cement (Parts)	Fine Aggregate (Parts)	Coarse Aggregate (Parts)
A	10	37,5	1	4	5
B ¹	15	19,0	1	3	4
C ²	20	19,0	1	2½	3½
D	25	19,0	1	2	3
E	30	19,0	1	2	2½

¹ Concrete strength for pole bases.

² Concrete strength for floor

Cement and aggregates shall be mixed by volume and the contents of a 50kg sack of cement shall be taken to be 0,033m³. **One wheelbarrow holds 1.5 packets of cement.** Water addition should be kept to a minimum. Only sufficient water should be used to produce a workable mix of 60-100mm slump. A recommended maximum water:cement ratio is 1 for a 10MPa; 0.8 for a 15MPa; 0.65 for a 20MPa; 0.59 for a 25MPa; 0.53 for a 30MPa mix, however the lower the ratio the better the durability of the concrete. Approximately 210 litres per m³ of concrete is required for an average quality sand and optimum quantity 19mm stone.

PLASTER CLASS:	MIX RATIO: (By Volume)	MASONRY CEMENT: kg	LIME: L	SAND: (loose and damp) L (max)
Rich mix (fdns, wetareas)	1 : 4	50	0-10	130
General purpose	1 : 5	50	0-40	165

MORTAR CLASS	MIX RATIO: (By Volume)	MASONRY CEMENT: kg	LIME: L	SAND: (loose and damp) L (max)
I	1 : 4	50	0-10	130
II	1 : 6	50	0-40	200

FINISHES TO IN-SITU CONCRETE

• **Class U1 Ordinary Finish**

Immediately after placing, the concrete shall be finished rough by screeding with the edge of a wooden board of straight and true line and working between guides set accurately to level.

No mortar shall be added and noticeable surface irregularities caused by the displacement of coarse aggregate shall be made good by rescreeding after removing or tamping down the offending aggregate.

• **Class U2 Wood Float Finish**

The concrete surface shall first be brought to the standard Class U1 ordinary finish and then floated with a wood float. Floating shall be started as soon as the screeded finish is stiffened sufficiently and bleed water has evaporated or been removed and it shall be the minimum necessary to produce a surface free from screed marks and uniform in texture.

• **Class U3 Coarse Brush Surface Finish**

The concrete surface shall first be brought to a Class U1 ordinary finish. A coarse brush finish is then applied with a coarse bristle brush. "Brushing" shall be started soon after screeding to produce a uniform patterned coarse surface finish with a rough surface texture in the direction of the desired drainage direction.

**• Class U4 Steel Float Finish**

The concrete surface shall first be brought to the standard Class U1 ordinary finish and then floated with a steel power float. Floating shall be started as soon as the screeded finish is stiffened sufficiently and bleed water has evaporated or been removed and it shall be the minimum necessary to produce a surface free from screed marks and uniform in texture.

6) TIMBER STRUCTURE: POLES

- .1 All poles crossing at right angles to be joined with 15mm threaded steel bars cut to size.
- .2 Half lap joints for poles (300-400mm overlap) and purlins (100-150mm) to be joined longitudinally.
- .3 Poles to be spaced 3.00m apart in concrete bases (600 x 465 x 465mm, Class B concrete with Class U1 surface finish to be used for all concrete bases: 15MPa/19mm, 1:3:4 mix, slump to SABS 1200GA 5.4.1.2 mass concrete). Bases must be free draining (no concrete under pole head).
- .4 3 x 2 poles of 3.6m x 100-125mm to be used as collar ties connecting the rafters on both sides of ridge beam support poles. Installation as below (page 13, figure 2). Only on inside rafters.
- .5 Top of centre poles to be cut into a V-shaped saddle to accommodate the ridge beam (Fig 1B).
- .6 Ridge beam to be placed in saddle and fastened with a steel flat bar (700 x 30 x 3.0mm) bent over the ridge beam and fastened with threaded bar (figure 1A and 1B). Do NOT use standard hoop irons.

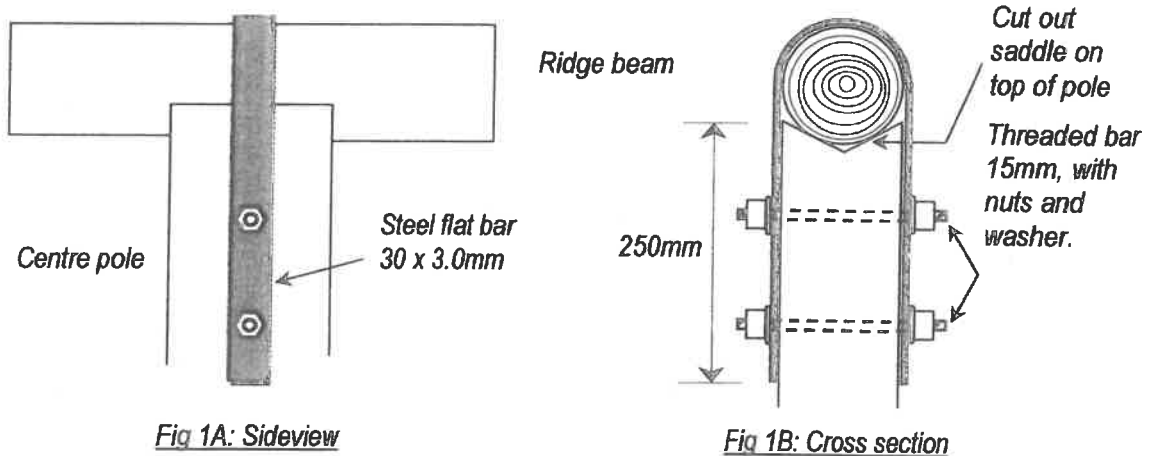

Figure 1: Securing the ridge beam on top of the centre poles.

7) ROOFING AND CLADDING:

- .1 The roof pitch is 11-12 degrees (see drawings) with an overhang of 200mm on sides and 150mm on ends.
- .2 0,5mm corrugated galvanized sheeting is to be fixed to purlins with self-tapping roofing bolts, hook bolts or equivalent, both as roofing and as cladding.
- .3 Bottom 300mm of the corrugated sheets used as cladding just above the block wall to be painted with bitumen based paint (see Corner Details drawing). Overlap between sheets at least one full rib (100mm). Top cladding sheet to overlap bottom one on the outside to prevent ingress of rain. Overhang of roof sheets 300-350mm.
- .4 Ridge capping (300mm on both sides of ridge) to be supplied and installed on roof and on cladding around corners.



Figure 2: Attachment of collar ties to the rafters

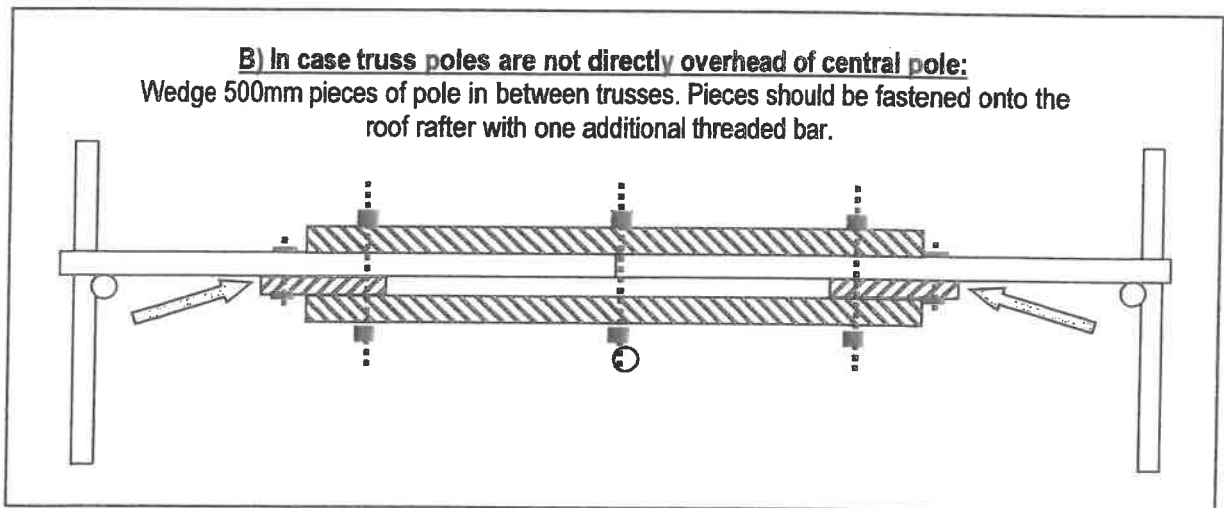
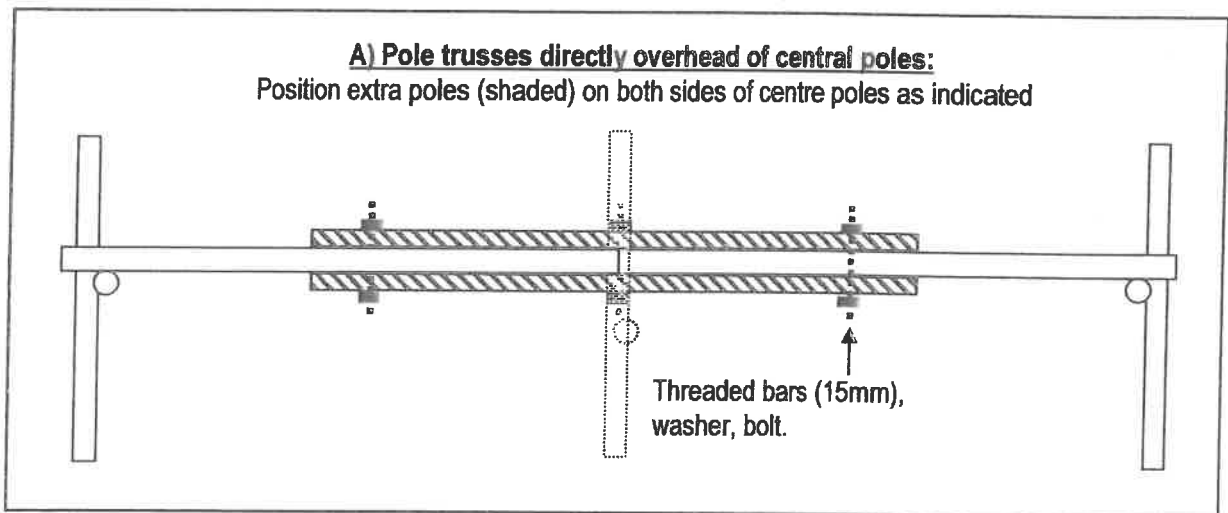
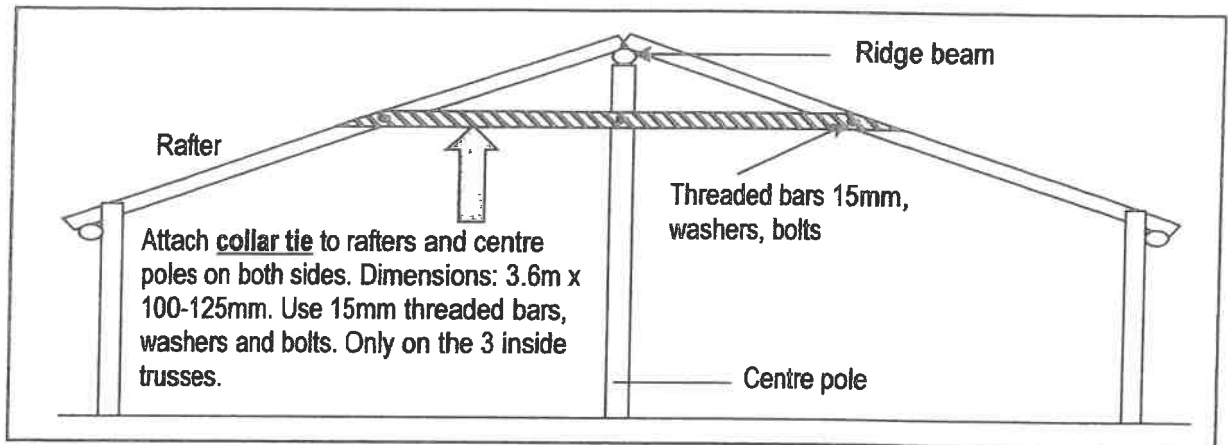

8) FLOORS

1 Sub-Base:

(1) The soil sub base under the floor slab is to be well and uniformly compacted. Backfilling & soil compaction to SABS 1200 DA (3.2; 5.2.3.2). The floors are to be on a leveled base and well compacted to minimum 95% Mod AASHTO – Contractor to supply test results proving compaction results – Department Engineer to be notified of test and observe test procedures. The floor sub base is to be inspected prior to the



pouring of any concrete. The base is to be inspected prior to laying of the damp proofing or pouring of any concrete.

(2) A 75mm thick **hard core layer consisting of crushed stone/gravel** is required on top of the compacted soil sub-base. It is to be well compacted.

(3) A 25mm layer of **coarse sand** is required on top of the stone to prevent the piercing of the damp proof course) and must be well and uniformly compacted.

.2 Pest control soil poisoning is to be applied under floor by reputable pest control specialists (registered with the Department of Agriculture and members of the pest control association). Certification is to be provided.

.3 Damp proof sheeting SABS (minimum 250 micron thickness) is required throughout the structure.

.4 **Reinforcing: No reinforcement is required.**

.5 **Floor:** Class C concrete and surface finishes as per drawing (min U2): $\geq 20\text{MPa}/19\text{mm}$, 1:2½:3½ mix, slump to SABS 1200GA (5.4.1.2). The floor and aprons are to be a minimum of 100mm thick with a class U2 finish. An inspection is required during the pouring of the concrete. A 500mm "jump zone" adjacent to the pallets is to be ribbed with wood float (see figure 3 on next page). Indentations app. 10 x 10 x 10mm. Wall to be built directly on floor, on strip of floor of increased thickness (200mm - see Par. 11.1 below).

.6 The floor slab is to be properly cured for a minimum period of seven days by keeping moist and covered over this time or by applying a concrete curing compound (applied as per manufacturer's specifications). The curing compound is to be applied after the floating process.

.7 **Joints:** The floor slab is to be jointed with joints spaced 2.00 x 2.00m. The entire floor must be cast in one pour and jointed using saw cuts 40mm deep to be done at the 'ideal' time (when slight raveling of the sawn surface is evident when cutting).

Fig.3: Floorfinish of jumpzone around drain centre (See 8.5: Floor)

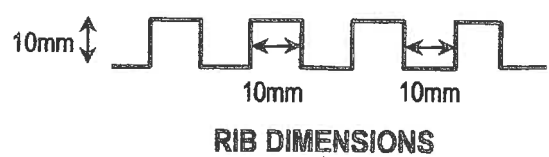
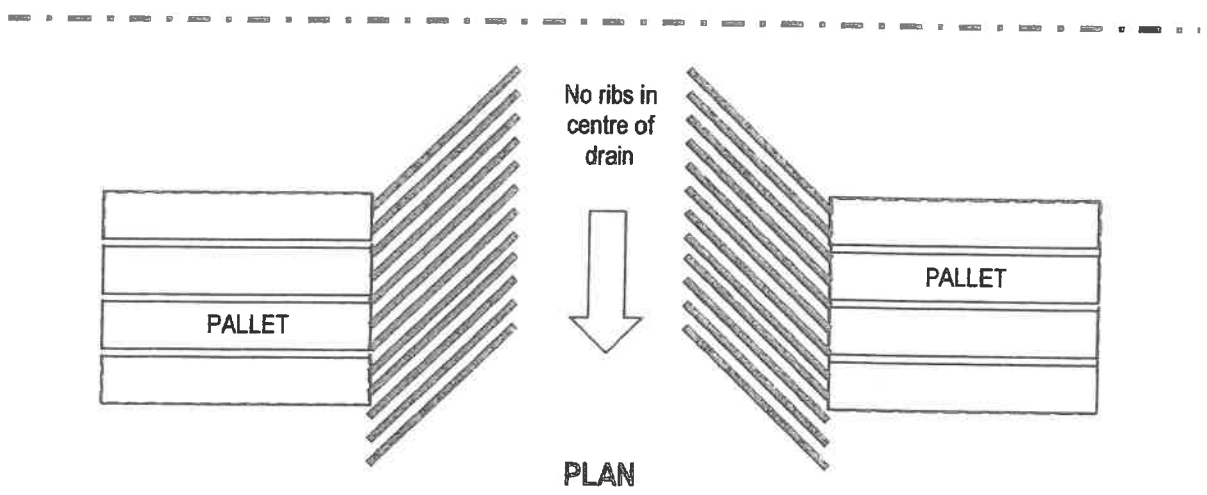
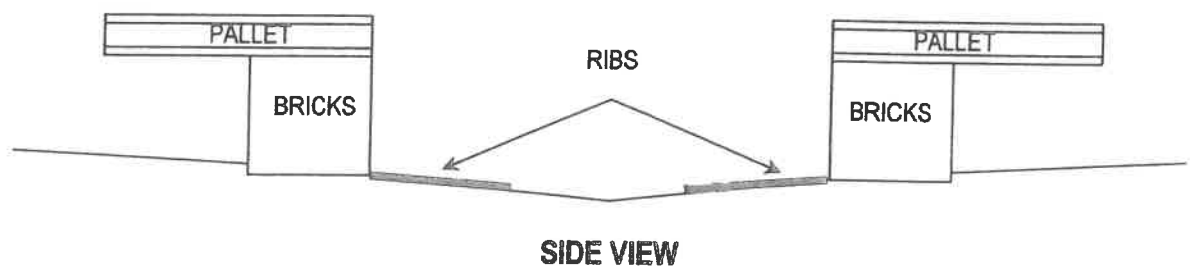



- .8 Keyed construction joints shall be placed as such that it will not be underneath walls or brick pillars. Keyed construction shall be made around supports, to join construction joints in the floors.
- .9 **Apron:** A concrete apron is to be constructed around the entire structure 1000mm wide. The dimensions are to be 75mm thick and slope away (5%) from the structure. The aprons are to be constructed in panels not exceeding 3m length x 1.0m wide.
- .10 **Ramp at entry:** Thickness: 100mm. Length: 3.00m Width: 5.00m at toe, narrowing to 4.00m at gate.

9) BRICK PILLARS

- .1 45 pillars to be constructed from burnt clay bricks to carry the pallets. Height of pillars: 3-5 courses depending whether a pillar is built along the wall or towards the middle of the floor. Each course is 4 bricks. The bricks shall be plastered. See figure 5 on page 18.
- .2 **Mortar:** Rich mix of bedding mortar (1: 3½) for pillar bottom. Standard class I mix (1:4) for joints.
- .3 **Plaster:** 10-15mm thick, rich mix (1:4) on sides. On top: extra rich 1:3½ mix.

10) SHED GATE

- .1 Two galvanized steel gate frames, 32 mm nominal bore (2mm), 1.5 x 2.0m each, with horizontal brace at 1.0 height (flat bar steel or round 32mm).
- .2 Frame to be clad with weld mesh (50 x 50 x 2.5mm) on inside welded onto frame.
- .3 Two eyes welded on inside of each gate for padlock. Size of Opening in weld mesh to access padlock: 200 x 150mm. Padlocks to be solid brass or zinc and of good quality (Sobo, Master, Yale, Union or Abus).
- .4 Hinges: 90deg. 15mm steel bar with eye, + nut and washer, or equivalent.

11) FENCING

- .1 13 strand 1.8m mesh fencing (pre-manufactured hinge joint fence- Bonnox or similar). Perimeter: 25 x 20m.
- .2 **Creosoted poles** of 2.7m length (Ø100-125mm), to be placed 3.0 metres apart in 600mm augered holes. All corner poles in free-draining (no concrete under pole) concrete (15Mpa/19mm) base. Concrete base dimensions: 300 x 300 x 600mm.
- .3 Use 32mm wire staples (5 per pole) to affix fence to pole.
- .4 **Straining wires** to be of 3.15mm thickness. 4 straining wires in total to be fixed unto the poles: 3 to cover the mesh fence height, 1 for the razor wire. At least 3 (three) binding wire connections per wire between poles. Straining wire to be properly strained.
- .5 **Razor wire coils** to run above fence properly fixed to poles, top of weld mesh and straining wire.
- .6 **Entry gate in fence** at front of shed: as shed gate, but with vertical frame elements extended for attachment of razor wire. (see figure 4). Poles to be of 3.0m length with concrete foot 300 x 300 x 600mm. With regards to locking a combination of a hardened chain and padlock of the makes mentioned under 13) can be used as well.
- .7 For further specifications; see Fencing drawing.

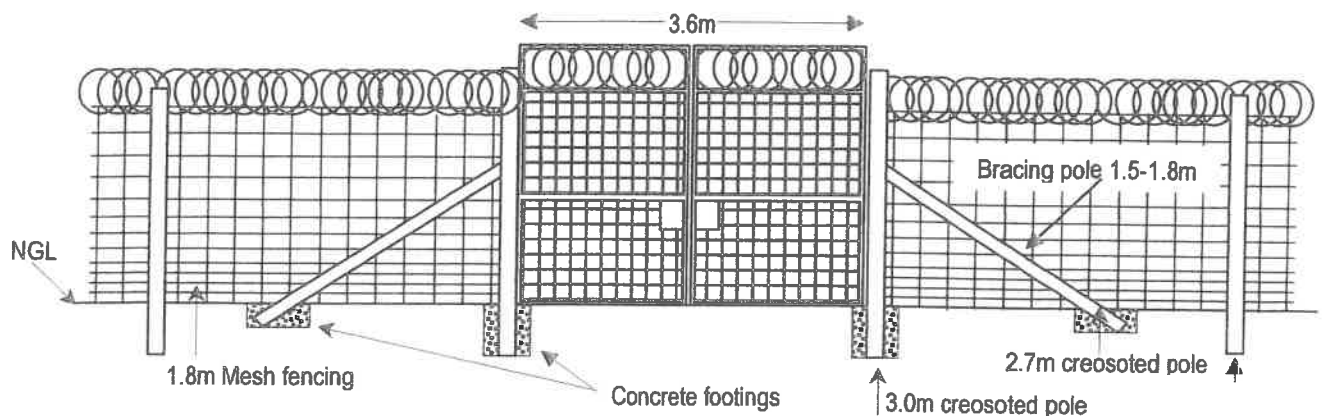

Fig.4: Fencing and entry gate (See 14.6: Fencing - Entry gate)



12) WELD MESH

- .1 Weld mesh will be used above the corrugated iron and fixed to the poles and/or purlins with staples.
- .2 It will also be used to close off the space between the pallets and floor to prevent animals from going underneath the pallets (See figure 5 on next page). Here it will be fixed against the brick pillars on the inside. Use Rawl bolts and washers that overlap the mesh gaps).

13) PALLETS

- .1 Dimensions: Except for the two center pallets in the back all 24 pallets are 1500 x 1500 x 125mm. Two pallets are 1500 x 1400 x 125mm.
- .2 Total net width all pallets is 7.50m, +2 x 50mm purlins + 2 x 150mm walls, leaves 100mm, or 25mm in between the pallets for maneuvering them.

Fig.5: Pallet configuration and pillar distances

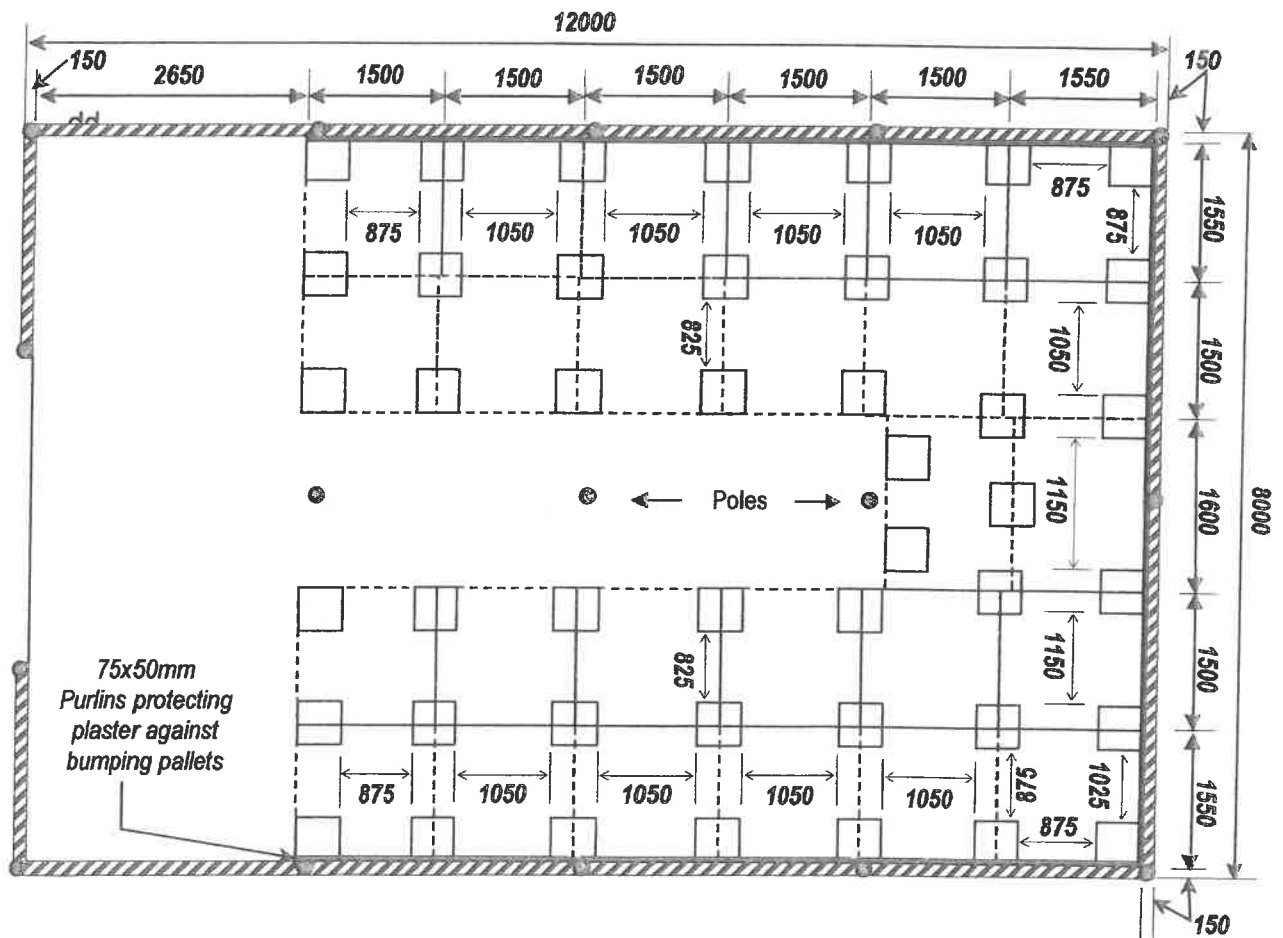

**BILL OF QUANTITIES CORRUGATED IRON GOAT SHED (100 ANIMALS) – PAGE 1**

		UNIT	QTY	RATE	TOTAL (ex VAT)
<u>SHED</u>					
Galvanized Corrugated Iron					
1	ROOF: Galvanized corrugated iron sheets 4500 x 610 x 0.5mm	No	42		
2	WALLS: Galvanized corrugated iron sheets 3300 x 610 x 0.5mm	No	16		
3	WALLS: Galvanized corrugated iron sheets 3000 x 610 x 0.5mm	No	6		
4	WALLS: Galvanized corrugated iron sheets 2400 x 610 x 0.5mm	No	4		
5	WALLS: Galvanized rooftop capping (also used for shed corners)	m	20		
Timber					
6	NAIL PLATED CCA TREATED POLES: 3.0m x 100-125mm	No	12		
7	NAIL PLATED CCA TREATED POLES: 3.6m x 100-125mm	No	20		
8	NAIL PLATED CCA TREATED POLES: 4.2m x 100-125mm	No	36		
9	NAIL PLATED CCA TREATED POLES: 4.8m x 75-100mm	No	3		
10	NAIL PLATED CCA TREATED POLES: 0.75m x 100-125mm	No	1		
11	PURLINS: pre-treated SABS approved pine 6000 x 75 x 50 mm	No	52		
12	PALLETS (Saligna), 1500 x 1500 x 126mm;	No	26		
Steel					
13	Welded mesh 50 x 50 x 2.5mm in rolls of 1.2 x 30m (fully galvanized)	No	2		
14	Galvanized steel gate frame: 32mm nominal bore 1.5 x 2.0m.	No	2		
15	Hinges for gates	No	4		
16	Solid Brass or zinc Padlock: Sobo/ Master/Yale/ Union/Abus- no cheap ones).	No	1		
17	Roof nails: packet of 100 galvanized steel roof nails (60mm,) + washers.	No	8		
18	Galvanized steel nails 100mm for purlins and pallet bumper	kg	5		
19	Threaded bars 15mm + washers + nuts to connect poles	m	40		
20	Steel flat bars (700 x 40 x 3.0mm) to secure ridge beam to inside centre poles	No.	3		
21	Hurricane clips	No	150		
Bricks					
22	Burnt clay bricks 220 x 110 x 70mm to elavate pallets	No	672		
23	M150 cement blocks 400 x 200 x 150mm	No	150		
24	Brickforce 2.5mm x 150mm (roles of 20m)	No	0		
Concrete for floor and ramp & bedding mortar for brickwork					
25	Pockets of cement	No	100		
26	Sand	m ³	11		
27	Stones	m ³	11		

**BILL OF QUANTITIES CORRUGATED IRON GOAT SHED (100 ANIMALS) PAGE 2**

Miscellaneous				
28	Bitumen paint to prevent corrosion of wall sheets	L	10	
29	Acid and water resistant wall paint (dark yellow/ochre)	L	10	
30	Plaster primer (white)	L	10	
31	Polyvin tint pastel wall paint	L	10	
32	Ant poison for 150m ² . Specify product:	Sum	1	
33	Damp proofing (250 micron thickness)	m ²	150	
<u>FENCING (Total length fencing 20 x 15m = 70m)</u>				
34	Mesh fencing (Bonnox or equivalent) 100m, 13 strand 150mm	Rolls	1	
35	Razor wire coils of 15m x 2.0mm	Rolls	5	
36	Creosote poles 2.7m x 100-125mm	No	34	
37	Wire staples 32mm/500g/pack	No	2	
38	Straining wire 3.15mm-roles of 5kg (app. 80m)	No	3	
39	Binding wire 2mm thick - roles of 5 kg (app. 200m)	No	1	
40	Galvanized steel gate: round bar (42 x 2.0mm) 1.5 x 2.0m, with razor wire on top.	No	2	
41	Hinge for gates: 90deg bent 15mm steel bar + nut and washer	No	4	
42	Solid Brass/zinc padlock (Sobo/ Master/Yale/ Union/Abus-no cheap ones)+ chain.	No	1	
<u>GENERAL</u>				
43	Site preparation and leveling	Sum	1	
44	Labour & Super vison	Sum	1	
45	Ancillary Services, Materials & Equipment	Sum	1	R 20,000 R 20,000
46	SUB TOTAL			
47	VAT 14%	Sum	1	
48	TOTAL			



ANNEXURE B : Payment Schedule - Goat shed

PAYMENT #	PHASE DESCRIPTION	App. % of contract	Payment after completion of phase	
1	Preliminary and general/Site establishment 1) Insurances, project risk, workmans compensation, UIF Etc. 2) Project administration, services, external services, testing, safety, provision of all required equipment for works at required times etc 3) Site preparation and establishment (includes plant transport to site).	8%	7%	
2*	Timber work and floor preparation 1) Setting out of the works 2) Erection of the poles in concrete base 3) Construction of timber wall and roof structure; 4) Completion of roofing.	16%	14%	
3	Flooring (preparation) 1) Excavate to final floor levels-stockpile soil or dispose as ordered. 2) In-situ material compacted to Engineer's approval. 3) Soil treatment (ant poisoning). 4) Complete application and compaction of floor base (50mm of crushed stone and 25mm of coarse sand) 5) Provide and install formwork for floor & aprons (suitably braced).	16%	14%	
4	Flooring (casting of all concrete) 1) Supply, mix, pour, compact, finish and cure concrete for floor to specification.	20%	17%	
5	Cladding, walling, brick work, mesh 1) 2 course block wall completed, including plastering and bagwash 2) Wall cladding fixed to perlins; 3) Brick pillars completed. 4) Welded mesh fixed to timber frame; 6) Welded mesh installed against pillars to prevent entry under pallets; 7) Gate installed.	25%	21%	
6	Fencing 1) All fencing erected 2) Gate installed.	15%	12%	22%
	b) Retention money 10% at practical completion	--	10%	
7	Retention money 5% at final completion after 90 days	0% if no defects	5%	
	TOTAL	100%	100%	



ANNEXURE C

ADDITIONAL INFORMATION

EQUIPMENT & RESOURCES:

Please provide an indication of the equipment and resources which will be available to execute the services required:

No	Equipment and resources available in order to execute the services:
1	
2	
3	
4	
5	

SUB CONTRACTED WORKS: Please list which parts of the works will be sub-contracted.

No	Sub Contractor	Associated works	Percentage
1			
2			
3			
4			
5			



EXPERIENCE: Please indicate your experience and expertise by completing the table:

No	Name of project + Period	Project description	Role (self or sub- contracted)	Project value	Name and contact number of referee
1					
2					
3					
4					
5					

**PALLET SUPPLIERS FOR GOATSHEDS WHO HAVE BEEN CONSULTED
AND ASSISTED WITH THE DRAWING UP OF THE SPECIFICATIONS:**

1. HOLA TIMBERS

89 Pentrich Avenue, Pietermaritzburg
Contact: James Ngema 033-3462261

2. WOODRITE

29 Wigford Road
Mason's Mill, Pietermaritzburg
Telephone: 033-3980571/4

Notes:

REVISIONS					
No.	Date	Grid	Description	By	Checked
1	07/12		New Title Block	RON	

KZN DEPARTMENT OF AGRICULTURE & RURAL DEVELOPMENT



ENGINEERING SERVICES

4 PINOAK AVENUE / PRIVATE BAG X6005
HILTON / 3245 / PHONE : 033-3438300
FAX : 0333438443

CHECKED FOR: KZNDIAE

PR. ENGINEER

DATE

CLIENT:

GOAT SHED FOR 100 ANIMALS

DRAWING 1 ELEVATIONS

USE : STANDARD DESIGN					
DRAWN	R. DE NEEF	SURVEYED	DESIGNED	R. DE NEEF	B. WHITTAL
DATE	29 Oct. 2008	CHECKED	YEAR	2008	2008
SCALE	1:50 (A3)	CHECKED	YEAR	2008	2008
DRAWING	INITIALS	YEAR	SCALE	NO.	CATEGORY

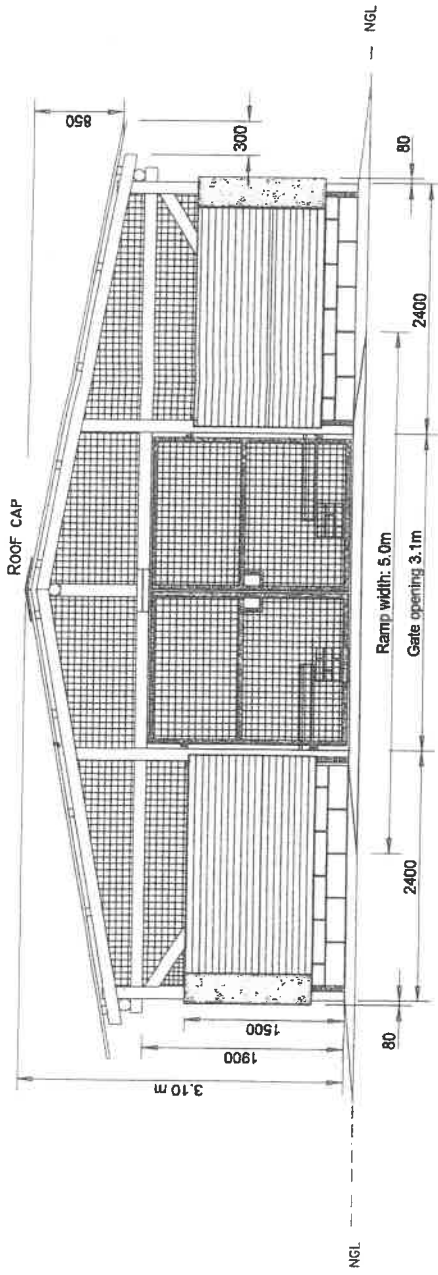

FRONT

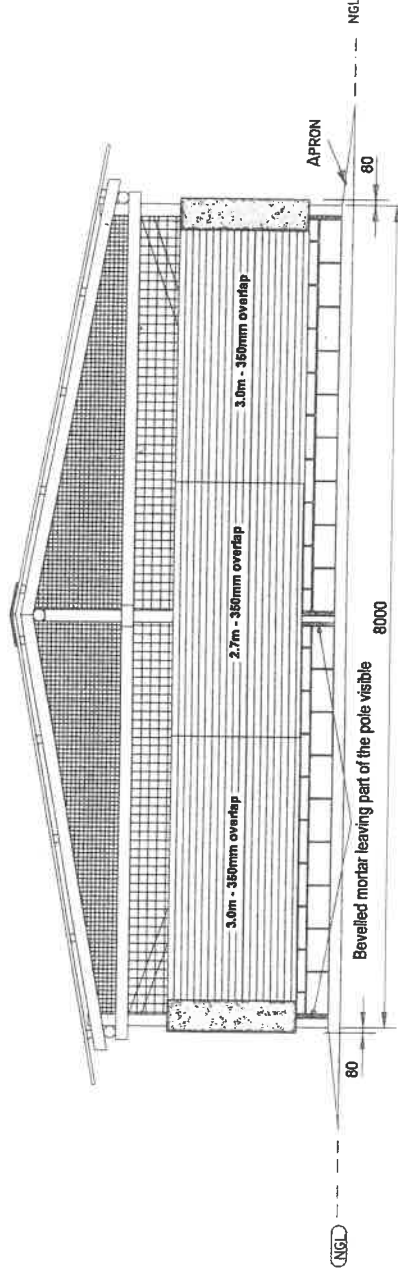

BACK

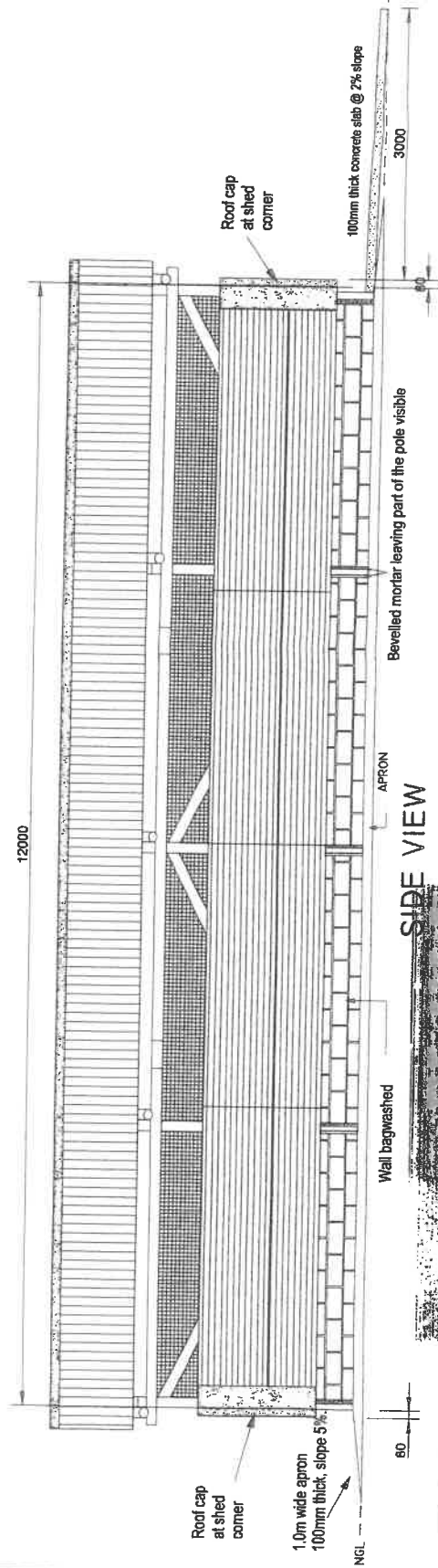

SIDE VIEW

PURLINS

- (6) 6000 x 75 x 50mm: 32
 - (7) 5600 x 75 x 50mm: 2
 - (8) 4100 x 75 x 50mm: 6
 - (9) 3900 x 75 x 50mm: 2
 - (10) 3600 x 75 x 50mm: 2
 - (11) 2400 x 75 x 50mm: 4
 - (12) 800 x 75 x 50mm: 16
- > Total no. of 6.0m purlins:
32 + 13 = 45

CCA TREATED POLES

- (15) 2.7m x 100-125mm: 2
- (1) 3.0m x 100-125mm: 10
- (13) 3.3m x 100-125mm: 8
- (2) 3.6m x 100-125mm: 6
- (3) 4.2m x 100-125mm: 22
- (4) 4.8m x 100-125mm: 3
- (5) 0.75m x 100-125mm: 1

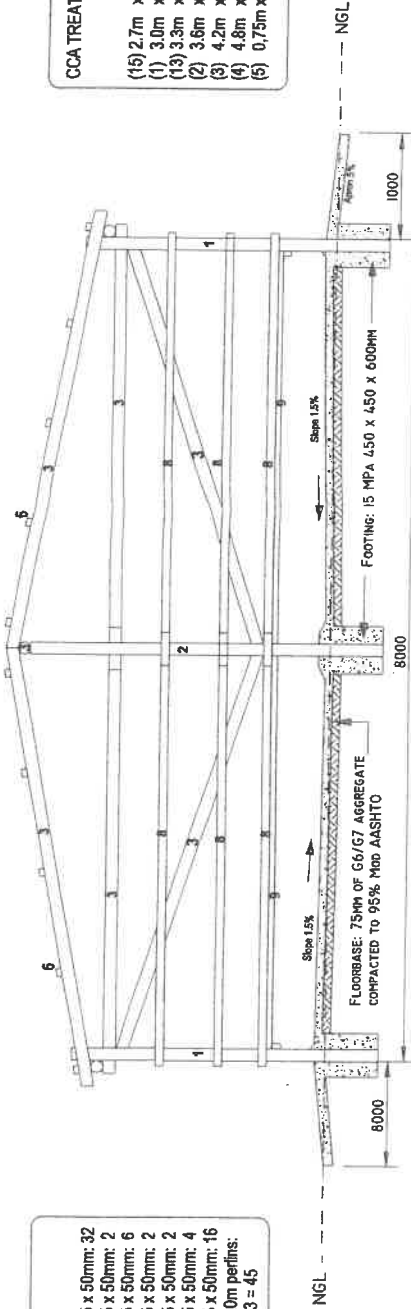

POLE FRAME WORK (BACK) SHOWING FLOOR, BASE & CONCRETE FOOTING

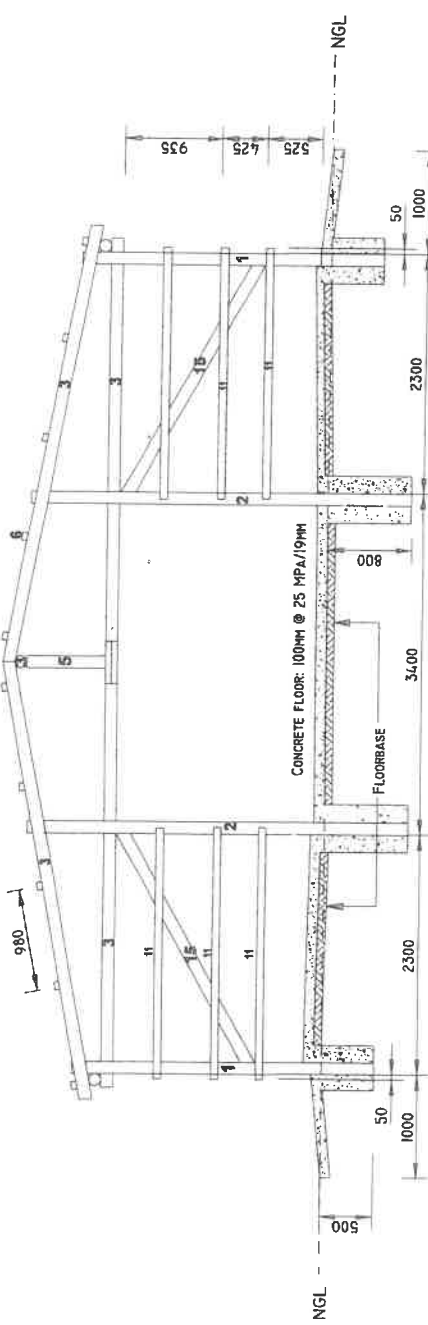

POLE FRAME WORK (FRONT) SHOWING FLOOR AND CONCRETE FOOTING

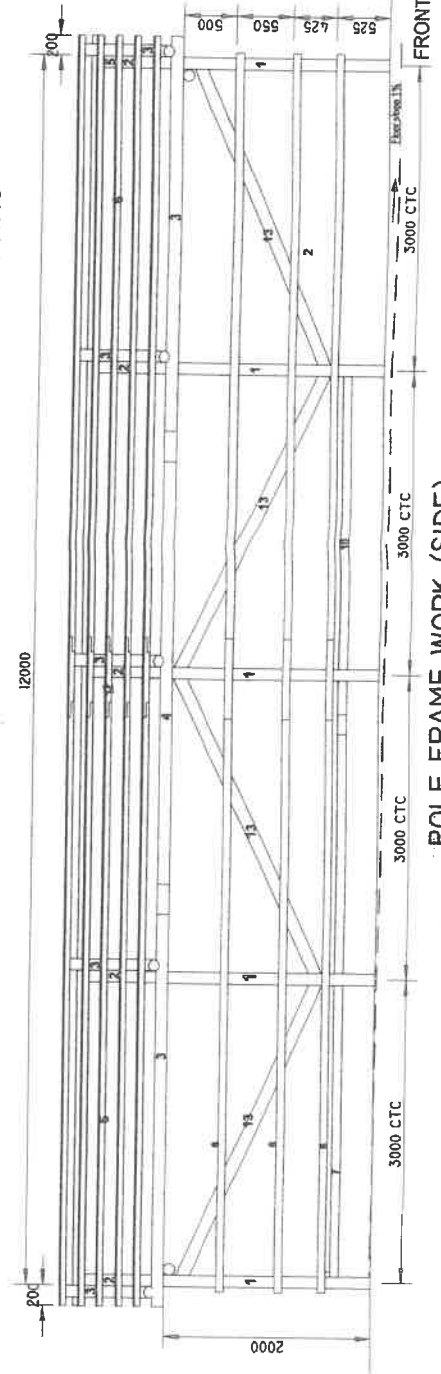

POLE FRAME WORK (SIDE)

Notes:

- 1) CONCRETE FLOOR 100MM @ 25 MPA/19MM
MIX: 1:2:3 BY VOLUME (WB = WHEELBARRROW)
> 2 BAGS CEMENT: 2 WB SAND : 3 WB STONE
- 2) CONCRETE APRON: 100MM @ 20 MPA/19 MM
MIX 1 : 2.5 : 3.5 BY VOLUME
2 BAGS CEMENT: 2.5 WB SAND: 3.5 WB STONE

REVISIONS

No.	Date	Grid	Description	By	Checked
1	1/15	..	NEW TITLE BLOCK, FLOOR, FLOOR BASE	Roh	

KZN DEPARTMENT OF AGRICULTURE & RURAL DEVELOPMENT



ENGINEERING SERVICES

4 PINDAK AVENUE / PRIVATE BAG 160005
HILTON / 3243 / PHONE : 033-3468300
FAX : 0333438443

CHECKED FOR KZINDAE

PR. ENGINEER

DATE

CLIENT:

GOAT SHED FOR 100 ANIMALS

**DRAWING 2
TIMBER FRAME
ELEVATIONS**

USE : STANDARD DESIGN

DRAWN	R. DE NEEF	SURVEYED
DATE	28 OCT. 2008	DESIGNED
SCALE	1:50 (A3)	CHECKED
DRAWING	INITIALS	YEAR
		SEQ. NO.
		CATEGORY

Notes:

- PALLET DIMENSIONS, NUMBERS & WEIGHTS**
1. DIMENSIONS: 1500 x 1500 x 126MM
 2. SLATES MAY BE 19MM THICK INSTEAD OF 25MM
 3. MADE OF PRE-HEATED TIMBER (SALIGMA)
 4. NUMBER OF PALLETS REQUIRED: 26.
 5. COMPOSITION PALLET:
 - > NUMBER OF SLATES: 15
 - > NUMBER OF CARRIERS: 3
 6. TOTAL WEIGHT/PALLET. APP. 55KG.
- TWO SUPPLIERS WHO ASSISTED WITH THE SPECIFICATIONS, BOTH BASED IN PMB
 COLLIN LOVE - WOODRITE: 082-3235013
 JACOB NGEHA - HOLA TIMBERS 033 346 2261

REVISIONS			
No.	DATE	DESCRIPTION	BY
1	07/12	NEW TITLE BLOCK	RPN

KZN DEPARTMENT OF AGRICULTURE & RURAL DEVELOPMENT



ENGINEERING SERVICES
 4 PINOAK AVENUE / PRIVATE BAG X8005
 HILTON / 32467 / PHONE : 033-3498900
 FAX : 0333498443

CHECKED FOR KZNDAE: _____ DATE: _____
 PR. ENGINEER: _____

CLIENT: _____

GOAT SHED FOR 100 ANIMALS
 DRAWING 3
PALLET FRAME TOP VIEW
 USE : STANDARD DESIGN

DRAWN	R. DE NEEF	SURVEYED	DESIGNED	R. DE NEEF
DATE	28 OCT. 2008	CHECKED	B. WHITTAL	YEAR
SCALE	1:50 (A3)	YEAR	NO	REVISION

- PURLINS**
- (6) 6000 x 75 x 50mm: 32
 - (7) 5600 x 75 x 50mm: 2
 - (8) 4100 x 75 x 50mm: 6
 - (9) 3900 x 75 x 50mm: 2
 - (10) 3600 x 75 x 50mm: 2
 - (11) 2400 x 75 x 50mm: 4
 - (12) 800 x 75 x 50mm: 16
- > Total no. of 6.0m purlins: 32 + 13 = 45

- CCA TREATED POLES**
- (15) 2.7m x 100-125mm: 2
 - (1) 3.0m x 100-125mm: 10
 - (13) 3.3m x 100-125mm: 8
 - (2) 3.6m x 100-125mm: 6
 - (3) 4.2m x 100-125mm: 22
 - (4) 4.8m x 100-125mm: 3
 - (5) 0.75m x 100-125mm: 1

- KEY**
- ① 3 Carriers of 1500 x 102 x 76mm.
 - ② 6 Slates of 1500 x 102 x 25 (19)mm
 - ③ 9 Slates of 1500 x 114 x 25(19)mm

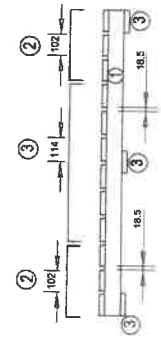
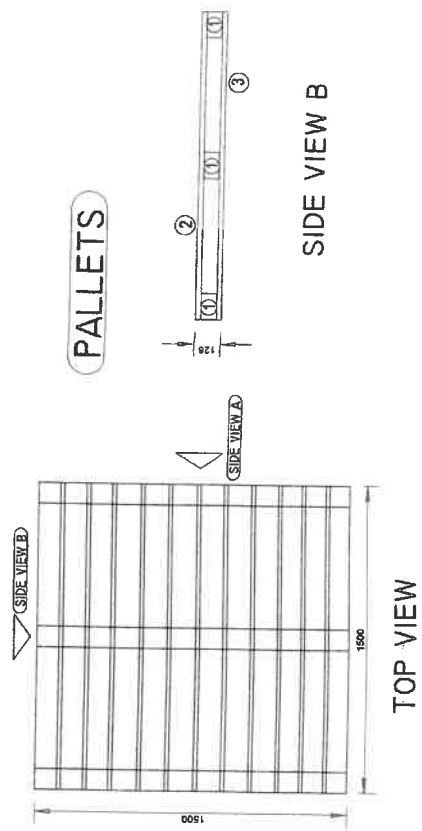
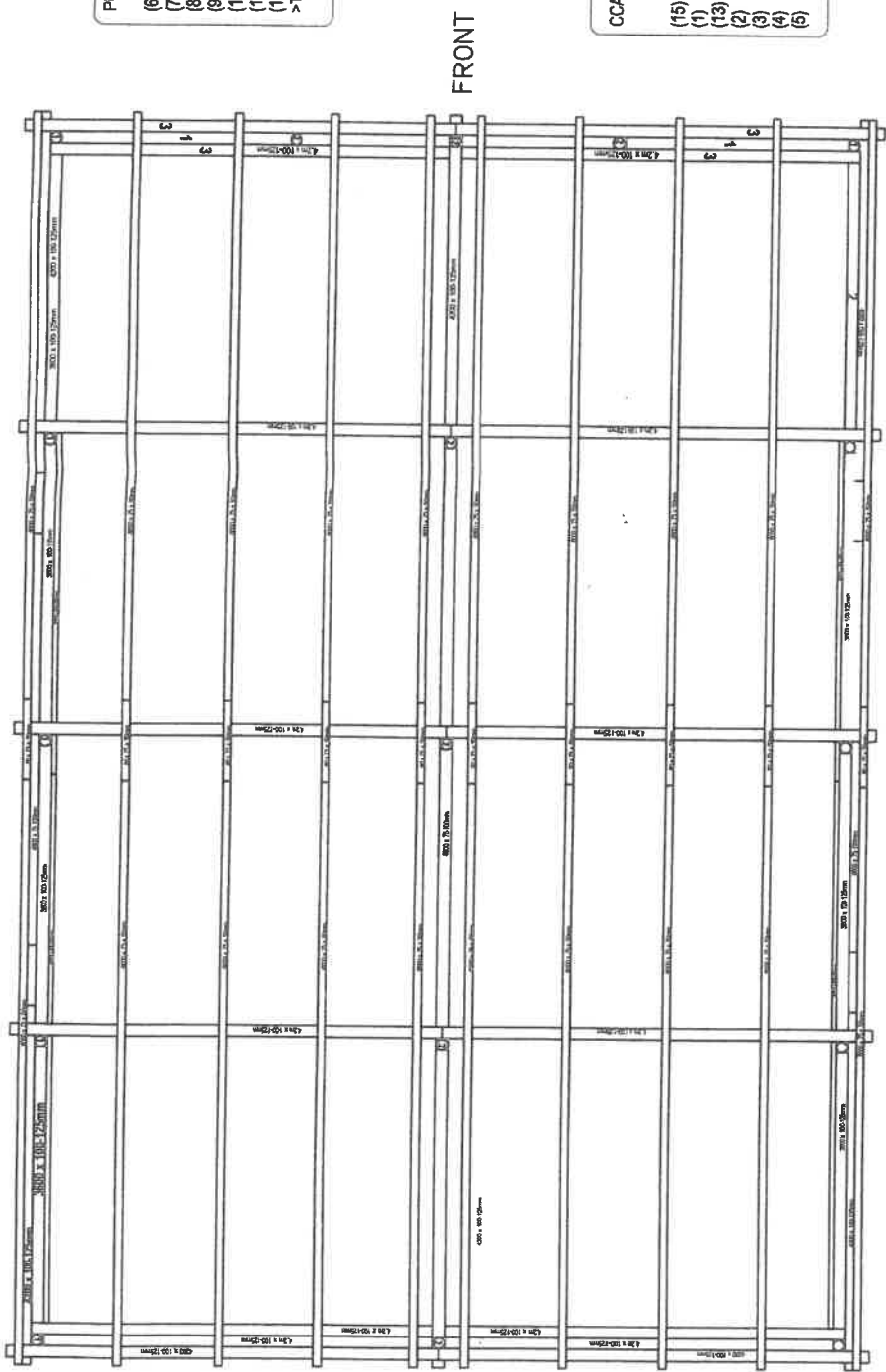

SIDE VIEW A

DECLARATION OF INTEREST

1. Any legal person, including persons employed by the state¹, or persons having a kinship with persons employed by the state, including a blood relationship, may make an offer or offers in terms of this invitation to bid (includes an advertised competitive bid, a limited bid, a proposal or written price quotation). In view of possible allegations of favouritism, should the resulting bid, or part thereof, be awarded to persons employed by the state, or to persons connected with or related to them, it is required that the bidder or his/her authorised representative declare his/her position in relation to the evaluating/adjudicating authority where-

- the bidder is employed by the state; and/or
- the legal person on whose behalf the bidding document is signed, has a relationship with persons/a person who are/is involved in the evaluation and or adjudication of the bid(s), or where it is known that such a relationship exists between the person or persons for or on whose behalf the declarant acts and persons who are involved with the evaluation and or adjudication of the bid.

2. **In order to give effect to the above, the following questionnaire must be completed and submitted with the bid.**

2.1 Full Name of bidder or his or her representative:

.....

2.2 Identity Number:

.....

2.3 Position occupied in the Company (director, trustee, shareholder², member):

.....

2.4 Registration number of company, enterprise, close corporation, partnership agreement or trust:

.....

2.5 Tax Reference Number:

.....

2.6 VAT Registration Number:

.....

2.6.1 The names of all directors / trustees / shareholders / members, their individual identity numbers, tax reference numbers and, if applicable, employee / PERSAL numbers must be indicated in paragraph 3 below.



¹"State" means –

- (a) any national or provincial department, national or provincial public entity or constitutional institution within the meaning of the Public Finance Management Act, 1999 (Act No. 1 of 1999);
- (b) any municipality or municipal entity;
- (c) provincial legislature;
- (d) national Assembly or the national Council of provinces; or
- (e) Parliament.

²"Shareholder" means a person who owns shares in the company and is actively involved in the management of the enterprise or business and exercises control over the enterprise.

Please clearly indicate, with an 'X' only one box that is applicable to your business or firm

2.7 Are you or any person connected with the bidder presently employed by the state?

YES	NO
-----	----

2.7.1 If so, furnish the following particulars:

Name of person / director / trustee / shareholder/member:

.....

Name of state institution at which you or the person connected to the bidder is employed

.....

Position occupied in the state institution:

.....

Any other particulars:

.....

2.7.2 If you are presently employed by the state, did you obtain

YES	NO
-----	----

the appropriate authority to undertake remunerative work outside employment in the public sector?

If yes, did you attach proof of such authority to the bid document?

YES	NO
-----	----

(Note: Failure to submit proof of such authority, where applicable, may result in the disqualification of the bid.)

2.7.2.1 If no, furnish reasons for non-submission of such proof:

.....

.....

2.8 Did you or your spouse, or any of the company's directors / trustees / shareholders / members or their spouses conduct business with the state in the previous twelve months?

YES	NO
-----	----

2.8.1 If so, furnish particulars:

.....

.....

2.9 Do you, or any person connected with the bidder, have any relationship (family, friend, other) with a person employed by the state and who may be involved with the evaluation and or adjudication of this bid?

YES	NO
-----	----

2.9.1 If so, furnish particulars.

.....

.....

2.10 Are you, or any person connected with the bidder, aware of any relationship (family, friend, other) between any other bidder and any person employed by the state who may be involved with the evaluation and or adjudication of this bid?

YES	NO
-----	----

2.10.1 If so, furnish particulars.

.....

.....

2.11 Do you or any of the directors / trustees / shareholders / members of the company have any interest in any other related companies whether or not they are bidding for this contract?

YES	NO
-----	----

2.11.1 If so, furnish particulars:

.....

.....

3 Full details of directors / trustees / members / shareholders.

Full Name	Identity Number	Personal Income Tax Reference Number	State Employee Number / Peral Number

4 DECLARATION

I, THE UNDERSIGNED (NAME).....

CERTIFY THAT THE INFORMATION FURNISHED IN PARAGRAPHS 2 and 3 ABOVE IS CORRECT.

I ACCEPT THAT THE STATE MAY REJECT THE BID OR ACT AGAINST ME SHOULD THIS DECLARATION PROVE TO BE FALSE.

.....
Name of bidder

.....
Position

.....
Signature

.....
Date

CERTIFICATE OF INDEPENDENT BID DETERMINATION

- 1 This Standard Bidding Document (SBD) must form part of all bids¹ invited.
- 2 Section 4 (1) (b) (iii) of the Competition Act No. 89 of 1998, as amended, prohibits an agreement between, or concerted practice by, firms, or a decision by an association of firms, if it is between parties in a horizontal relationship and if it involves collusive bidding (or bid rigging).² Collusive bidding is a *per se* prohibition meaning that it cannot be justified under any grounds.
- 3 Treasury Regulation 16A9 prescribes that accounting officers and accounting authorities must take all reasonable steps to prevent abuse of the supply chain management system and authorizes accounting officers and accounting authorities to:
 - a. disregard the bid of any bidder if that bidder, or any of its directors have abused the institution's supply chain management system and or committed fraud or any other improper conduct in relation to such system.
 - b. cancel a contract awarded to a supplier of goods and services if the supplier committed any corrupt or fraudulent act during the bidding process or the execution of that contract.
- 4 This SBD serves as a certificate of declaration that would be used by institutions to ensure that, when bids are considered, reasonable steps are taken to prevent any form of bid-rigging.
- 5 In order to give effect to the above, the attached Certificate of Bid Determination (SBD 9) must be completed and submitted with the bid:

¹ Includes price quotations, advertised competitive bids, limited bids and proposals.

² Bid rigging (or collusive bidding) occurs when businesses, that would otherwise be expected to compete, secretly conspire to raise prices or lower the quality of goods and / or services for purchasers who wish to acquire goods and / or services through a bidding process. Bid rigging is, therefore, an agreement between competitors not to compete.

CERTIFICATE OF INDEPENDENT BID DETERMINATION

I, the undersigned, in submitting the accompanying bid:

(Bid Number and Description)

in response to the invitation for the bid made by:

(Name of Institution)

do hereby make the following statements that I certify to be true and complete in every respect:

I certify, on behalf of _____ that:

(Name of Bidder)

1. I have read and I understand the contents of this Certificate;
2. I understand that the accompanying bid will be disqualified if this Certificate is found not to be true and complete in every respect;
3. I am authorized by the bidder to sign this Certificate, and to submit the accompanying bid, on behalf of the bidder;
4. Each person whose signature appears on the accompanying bid has been authorized by the bidder to determine the terms of, and to sign the bid, on behalf of the bidder;
5. For the purposes of this Certificate and the accompanying bid, I understand that the word "competitor" shall include any individual or organization, other than the bidder, whether or not affiliated with the bidder, who:
 - (a) has been requested to submit a bid in response to this bid invitation;
 - (b) could potentially submit a bid in response to this bid invitation, based on their qualifications, abilities or experience; and
 - (c) provides the same goods and services as the bidder and/or is in the same line of business as the bidder
6. The bidder has arrived at the accompanying bid independently from, and without consultation, communication, agreement or arrangement with any competitor. However communication between partners in a joint venture or consortium³ will not be construed as collusive bidding.

7. In particular, without limiting the generality of paragraphs 6 above, there has been no consultation, communication, agreement or arrangement with any competitor regarding:
- (a) prices;
 - (b) geographical area where product or service will be rendered (market allocation)
 - (c) methods, factors or formulas used to calculate prices;
 - (d) the intention or decision to submit or not to submit, a bid;
 - (e) the submission of a bid which does not meet the specifications and conditions of the bid; or
 - (f) bidding with the intention not to win the bid.
8. In addition, there have been no consultations, communications, agreements or arrangements with any competitor regarding the quality, quantity, specifications and conditions or delivery particulars of the products or services to which this bid invitation relates.
9. The terms of the accompanying bid have not been, and will not be, disclosed by the bidder, directly or indirectly, to any competitor, prior to the date and time of the official bid opening or of the awarding of the contract.
10. I am aware that, in addition and without prejudice to any other remedy provided to combat any restrictive practices related to bids and contracts, bids that are suspicious will be reported to the Competition Commission for investigation and possible imposition of administrative penalties in terms of section 59 of the Competition Act No 89 of 1998 and or may be reported to the National Prosecuting Authority (NPA) for criminal investigation and or may be restricted from conducting business with the public sector for a period not exceeding ten (10) years in terms of the Prevention and Combating of Corrupt Activities Act No 12 of 2004 or any other applicable legislation.

.....
Signature

.....
Date

.....
Position

.....
Name of Bidder